

CITY OF LETHBRIDGE  
Riverstone - Phase 22

PLAN SHOWING SURVEY OF  
SUBDIVISION  
OF PART OF  
Area 'A', Plan 141 2157 (S.W. 1/4 SEC. 24)  
AND PART OF  
S.W. 1/4 SEC. 24  
AND PART OF  
Lot 1, Block 2, Plan 041 4514 (N.W. 1/4 SEC. 13)  
ALL WITHIN  
TWP. 8, RGE. 22, W4 M.  
BY : D.J. AMANTEA, A.L.S.  
SCALE : 1:500

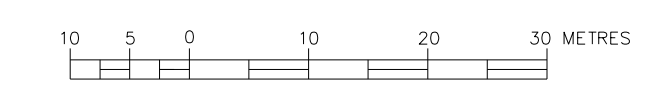

Fd.I. - Statutory Iron Posts found shown thus (648)  
P.I.I. - Statutory Iron Posts placed shown thus (679) marked '004'  
Temporary points shown thus (667) x (667)  
The positions where Iron Posts are to be placed pursuant to Sec. 47  
of the Surveys Act on Plan 151 3409 are numbered thus (694)  
and for coordinates see Plan Instrument 151 330 060  
The position of curve centres on Plan 151 3409  
are shown thus (cc710)  
Distances on curves are in metres and decimal parts thereof.  
cs stands for countersunk  
MR stands for Municipal Reserve  
R stands for radius  
d stands for delta angle  
(r) stands for radial bearing  
Distances on curves are Arc distances.  
B.C. stands for beginning of curve.  
E.C. stands for end of curve.  
P.R.C. stands for point of reverse curvature  
P.C.C. stands for point of change of curvature (tangency)  
All corner cut-offs are 5.000m x 5.000m  
The positions where Iron Posts are to be placed pursuant to Sec. 47  
of the Surveys Act are numbered thus (44)  
Curve centres are shown thus (cc46)  
Statutory Iron Posts planted pursuant to Sec. 47 of the Surveys Act are marked 'P004'  
Portion to be registered is bound in heavy black lines and contains 4.799 ha.

Bearings are GRID and are derived from Plan 151 3409 (164'18'14")  
Datum - NAD83 (original)  
Reference Meridian - 114°  
Projection - 3TM  
Combined Scale Factor - 0.999841  
RP - Geo-reference point shown thus (O) RP  
Coordinate value for geo-reference point is N:5502502.29 E:81732.35

NOTE:  
The 3 TM grid coordinate values for monuments found, placed or to be  
placed pursuant to Section 47 of the Surveys Act, and survey markers and  
reference monuments shown on this plan are listed in a table attached to the  
subdivision instrument.

CERTIFICATE : SECTION 47, SURVEYS ACT.  
REGISTERED ON \_\_\_\_\_  
AS NUMBER \_\_\_\_\_  
All Statutory Monuments were placed in the ground between the  
dates of \_\_\_\_\_ and are  
positioned in accordance with coordinates shown attached to the  
subdivision instrument, except for the following:

REGISTRAR

SURVEYOR  
NAME : D.J. AMANTEA, A.L.S.  
SURVEYED BETWEEN THE DATES OF AUGUST 9TH.,  
2013 AND SEPTEMBER 11TH., 2015, IN ACCORDANCE  
WITH THE PROVISIONS OF THE SURVEYS ACT.

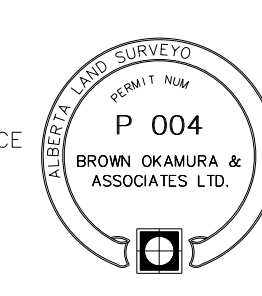

REGISTERED OWNER  
CITY OF LETHBRIDGE

SUBDIVISION AUTHORITY  
NAME : CITY OF LETHBRIDGE  
FILE NO. : SBD00478  
DATE APPROVED : \_\_\_\_\_

DRAWING FILE : 13-11911A.DWG  
CLIENT : CITY OF LETHBRIDGE  
FILE NO. : 13-11911A (8.9 sq.ft. - 3.7) p



AREA REQUIRED within S.W. 1/4 SEC. 24:  
from C. of T. 151 330 060 + 51 = 0.003 ha.  
from Area 'A', Plan 141 2157 = 0.084 ha.  
Subtotal = 0.087 ha.

AREA REQUIRED within N.W. 1/4 SEC. 13:  
from Lot 1, Block 2, Plan 041 4514 = 4.732 ha.  
TOTAL = 4.799 ha.

AREA WITHIN RESIDENTIAL LOTS 3.366 ha.  
AREA WITHIN STREETS, LANES & WALKWAYS 1.433 ha.

DETAIL 'B'  
1:100

DETAIL 'A'  
NOT TO SCALE

