

WESTMINSTER PARK

HISTORY

The name was for the Westminister District in London, England by William Lehman Ashmead Bartlett Burdett- Coutts, husband of Baroness Angela Burdett-Coutts.



The Lions Playground with swimming pool at right. Skating and hockey rink at the left, 1951. Galt Museum Archives 19851047005

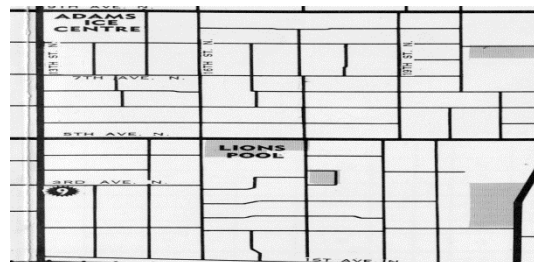

Tourist Bureau Map indicating the Lions Pool in North Lethbridge, ca 1960s. Galt Museum Archives 19811027000

The park was originally called Lions Playground, after the Lions Club of Lethbridge. The club was responsible for its early and ongoing development, including replacing the pool and the addition of a community centre. The pool was demolished in 1978 and a new one built with the new name Westminster Pool.

PHYSICAL LAYOUT



Westminster Park sign, 2013. Photo: T. Purkis



Westminster School built ca 1967 on 18 Street North; 2013. Photo: T. Purkis

This north side park occupies 3.59 acres bordered by 16th and 18th Streets and 3A and 5th Avenues North, and was developed in 1949. It is home to the Westminster School, Pool and Community Centre. The school is located on the south end of the area on 18th Street. This is the new Westminster School, not to be confused with the first Westminster School (1905-1968), built on 13th Street and 5th Avenue North.



Westminster Community Centre facing 15th Avenue North, 1991. Galt Archives 20031023003-055



The outdoor pool at the Community Centre, 2013. Photo: T. Purkis

ACTIVITIES



View of the Westminster Playground, 2013. Photo T. Purkis

Enhancement Project in 1990 when new equipment was purchased and the playground was updated.

The Community Centre has facilities for classes, activities such as meetings, presentations, educational classes, social function, receptions, banquets, parties, meetings and the Westminster Neighborhood Association meetings.

The outdoor pool is located on the north side of the centre. There are bleachers to the east and grassy areas for sunbathing. The Westminster playground was part of the City of Lethbridge Community Facilities



The Westminster School Community Play area sign, 2013. Photo T. Purkis



The Westminster School Community Play area open space, 2013. Photo: T. Purkis

The Westminster School Community Play Area is to the south of the playground. It is an open space adjoining baseball diamonds and sports field. There are tennis courts for for the public's use on the north side of the school.