

Civic Common Master Plan Final Open House

Welcome!



CITY OF
Lethbridge

Civic Common Master Plan – Study Area



CITY OF
Lethbridge

Civic Common Context

Civic
Common

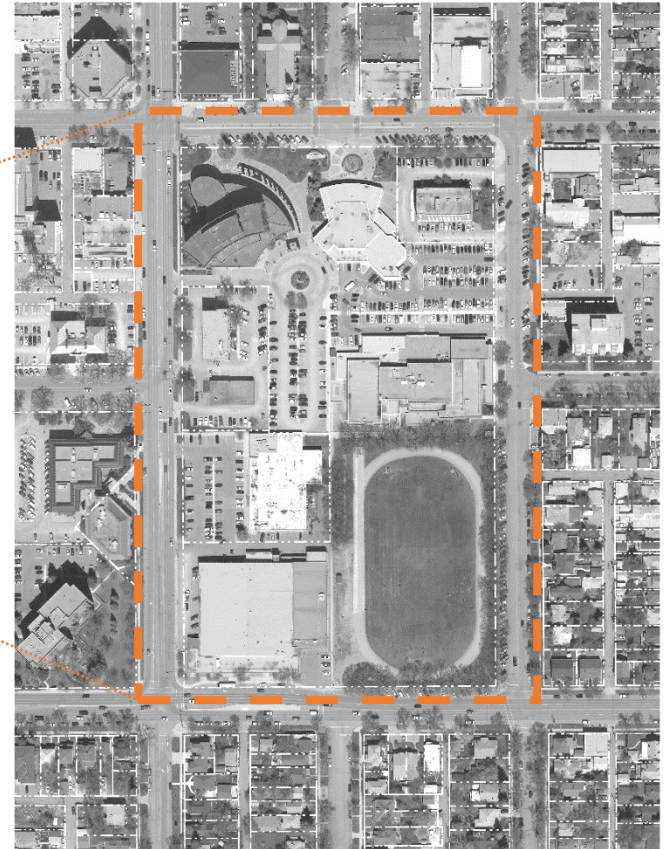
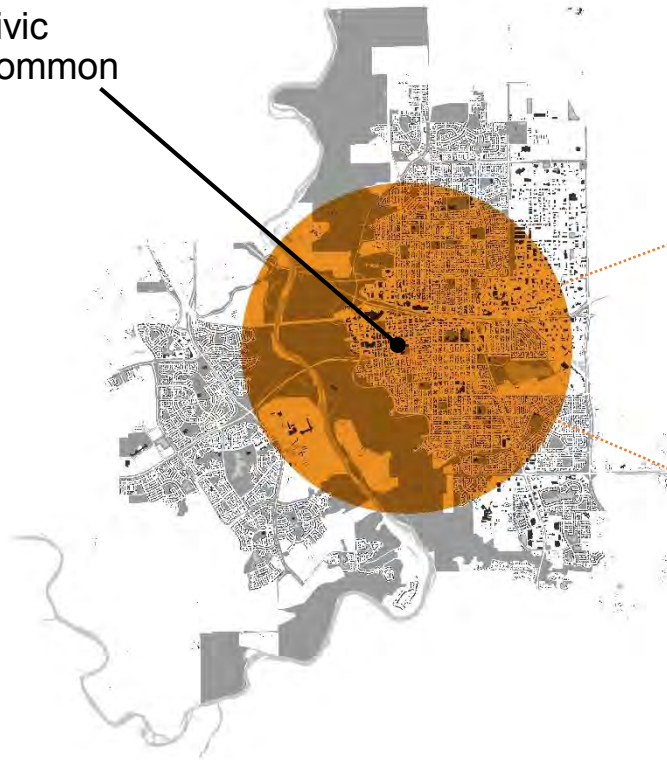

The Civic Common is a four square block, 7.3 ha area, that includes: City Hall, RCMP, YMCA, Civic Centre and Sports Field, Fritz Sick Centre and Yates Theatre.



CITY OF
Lethbridge

Civic Common Key Milestones

2018

Feb.

Mar.

Apr.

May

Jun.

Jul.

Aug.

Sept.

Oct.

Interim Report #1: Project Plan

Visioning Session

Interim Report #2: Issues and Visioning Report

Interim Report #3: SMT Report

Design Burst

Interim Report #4: Engagement Outcomes Report

Draft Master Plan and Phasing Strategy: June 8

On-line Engagement

Draft Master Plan Open House: September 20

Council Presentation/Consideration



CITY OF
Lethbridge

Civic Common Site History

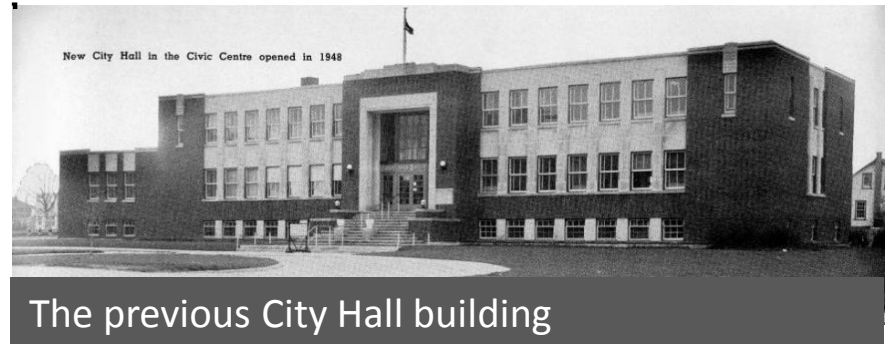
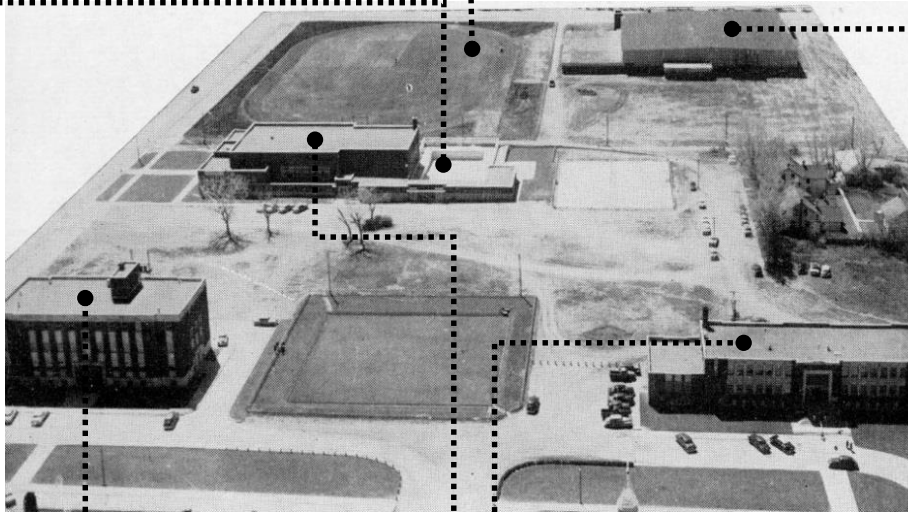

CITY OF
Lethbridge

Civic Common Existing Facilities

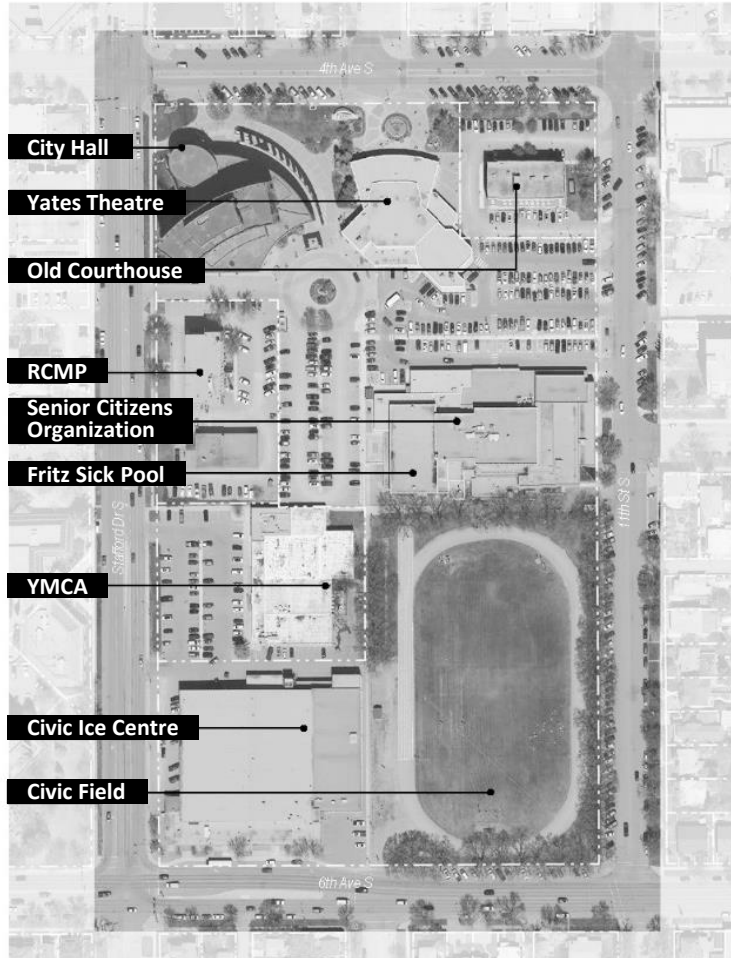

CITY OF
Lethbridge

MASTER PLAN

The master plan focuses on the public realm; the spaces between the buildings. It sets a framework for the general layout and orientation of existing and new buildings as they develop over time. Existing and new buildings and their uses are flexible and may be determined at various stages throughout the implementation. All buildings will have a civic focus but specific buildings and occupants are not yet determined.

ORGANIZING ELEMENTS

The Organizing elements set a new framework which defines outdoor rooms at the heart of the Civic Common. The quality, scale and materiality of the built form must work to complement and frame the following outdoor rooms:



FRONT
LAWN

CELEBRATION WAY

CIVIC PLAZA

CIVIC LANE

MARKET
PLAZA

REVITALIZING ELEMENTS

The Civic Common is rich with assets and opportunities. The following elements require revitalization to ensure that they thrive well into the future:

- The Civic Green
- Parking Concepts
- Boundary Conditions

FRAMING ELEMENTS

Currently a common language and scale frames the Front Lawn and Celebration Way. City Hall and the Yates building set a standard for animation, materiality, scale, and presence on the site. Future development must take into consideration:

- Alignment with the plan
- Building siting, orientation, character
- Microclimate considerations
- Catalyst potential
- Interim uses



CITY OF
Lethbridge

Civic Common Master Plan

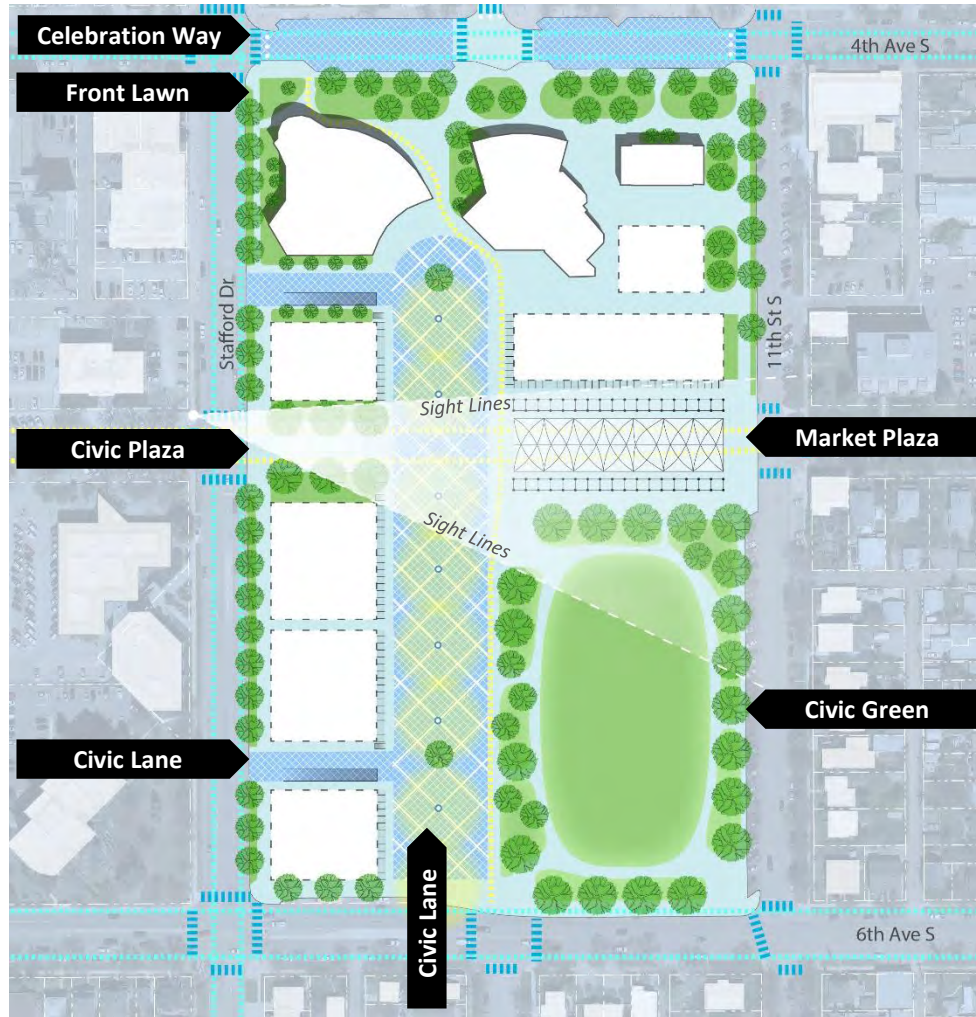

Organizing Elements



FRONT LAWN
CELEBRATION WAY
CIVIC PLAZA
MARKET PLAZA
CIVIC LANE

- | | | | |
|--|-----------------------------|--|-------------------------|
| | Multi-Use Hard Surface | | Canopy Structure |
| | Pedestrian Hard Surface | | Event Support Structure |
| | Landscaping | | Active Frontage/Canopy |
| | Multi-Use Path and Lighting | | 5th Avenue Sight Lines |
| | Proposed Bicycle Route | | Civic Building Site |



CITY OF
Lethbridge

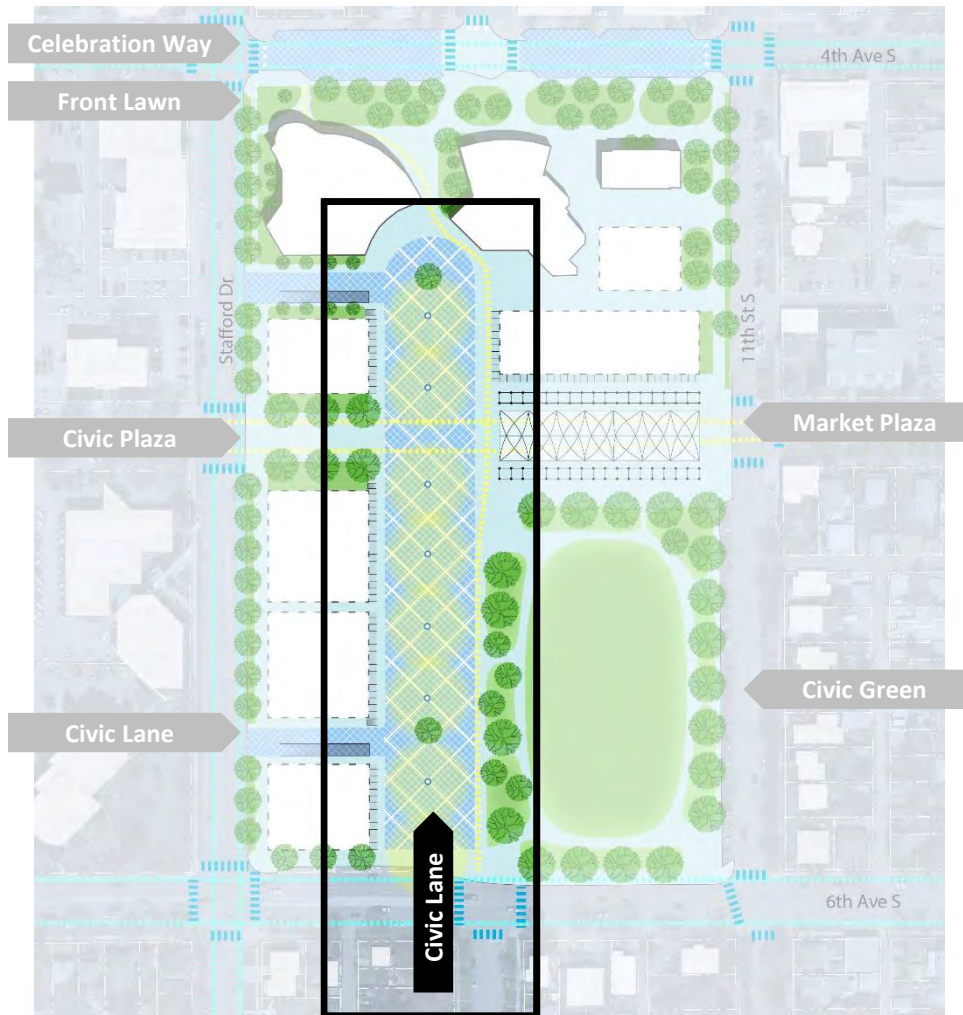

- | | | | |
|--|-----------------------------|--|-------------------------|
| | Multi-Use Hard Surface | | Canopy Structure |
| | Pedestrian Hard Surface | | Event Support Structure |
| | Landscaping | | Active Frontage/Canopy |
| | Multi-Use Path and Lighting | | Civic Building Site |
| | Proposed Bicycle Route | | |

Civic Lane

The main element of the master plan is the highly adaptable **Civic Lane**. It is conceived as a linear multi-use public space. The Civic Lane is used for parking at times while at other times it can be used for festivals, market purposes, and civic events. The design of this space uses a high-quality paver that gives an aesthetic of an active place for people, bicycles as well as their cars.



CITY OF
Lethbridge

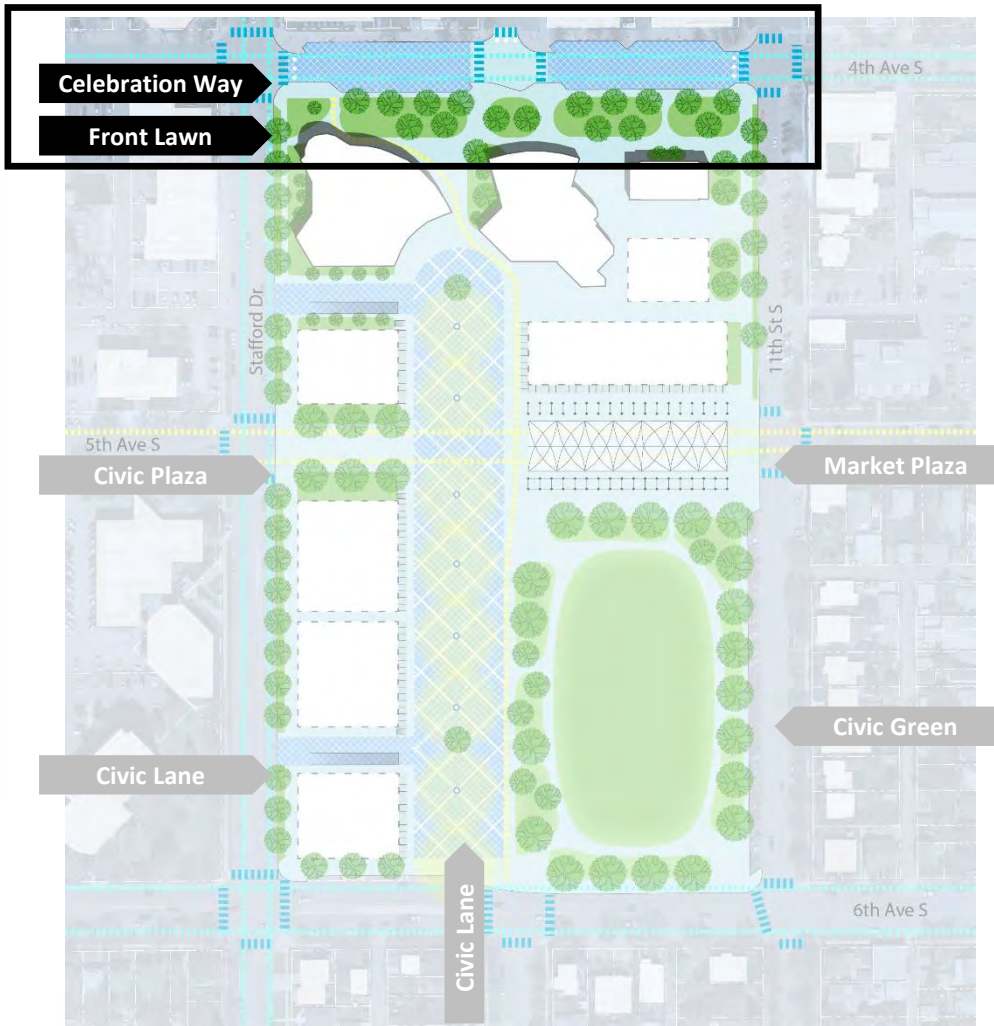

Celebration Way + Front Lawn



4th Avenue South is the **Celebration Way** for large parades and gatherings during significant events such as Remembrance Day.

The **Front Lawn** welcomes the public into the Civic Common. With a landscaped green lawn, large trees, and hardscaped areas that lead pedestrians into the heart of the Civic Common.



CITY OF
Lethbridge

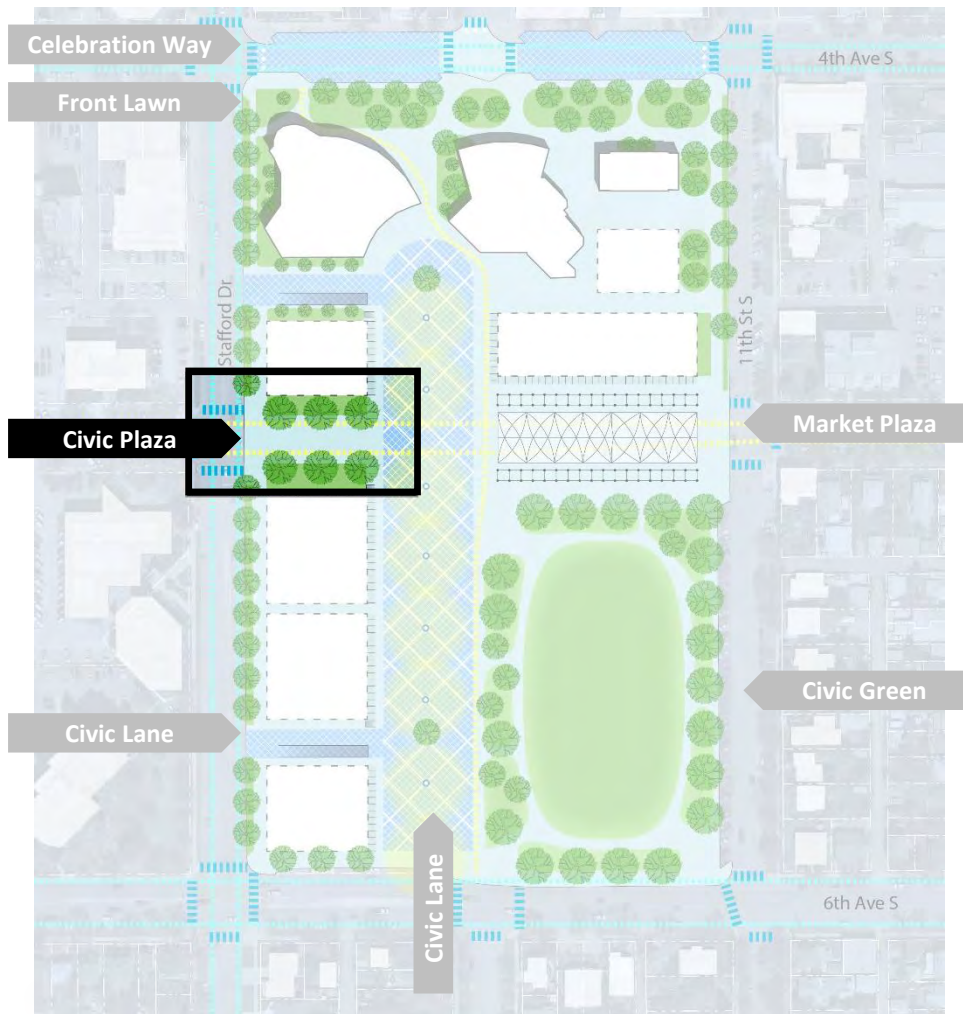

- | | | | |
|--|-----------------------------|--|-------------------------|
| | Multi-Use Hard Surface | | Canopy Structure |
| | Pedestrian Hard Surface | | Event Support Structure |
| | Landscaping | | Active Frontage/Canopy |
| | Multi-Use Path and Lighting | | Civic Building Site |
| | Proposed Bicycle Route | | |

Civic Plaza

The grand pedestrian and cycling entrance is located on the western side of the Civic Common aligned with 5th Ave South promenade and as a public space counterpoint to the Galt Museum. The **Civic Plaza** acts as a gateway to the Civic Lane as well as a privileged view into the heart of the Civic Common. The Civic Plaza is welcoming to pedestrians and cyclists alike. It offers an opportunity for through connection for future cycling lanes planned along 5th Avenue, as it connects through to the Market Plaza.



CITY OF
Lethbridge

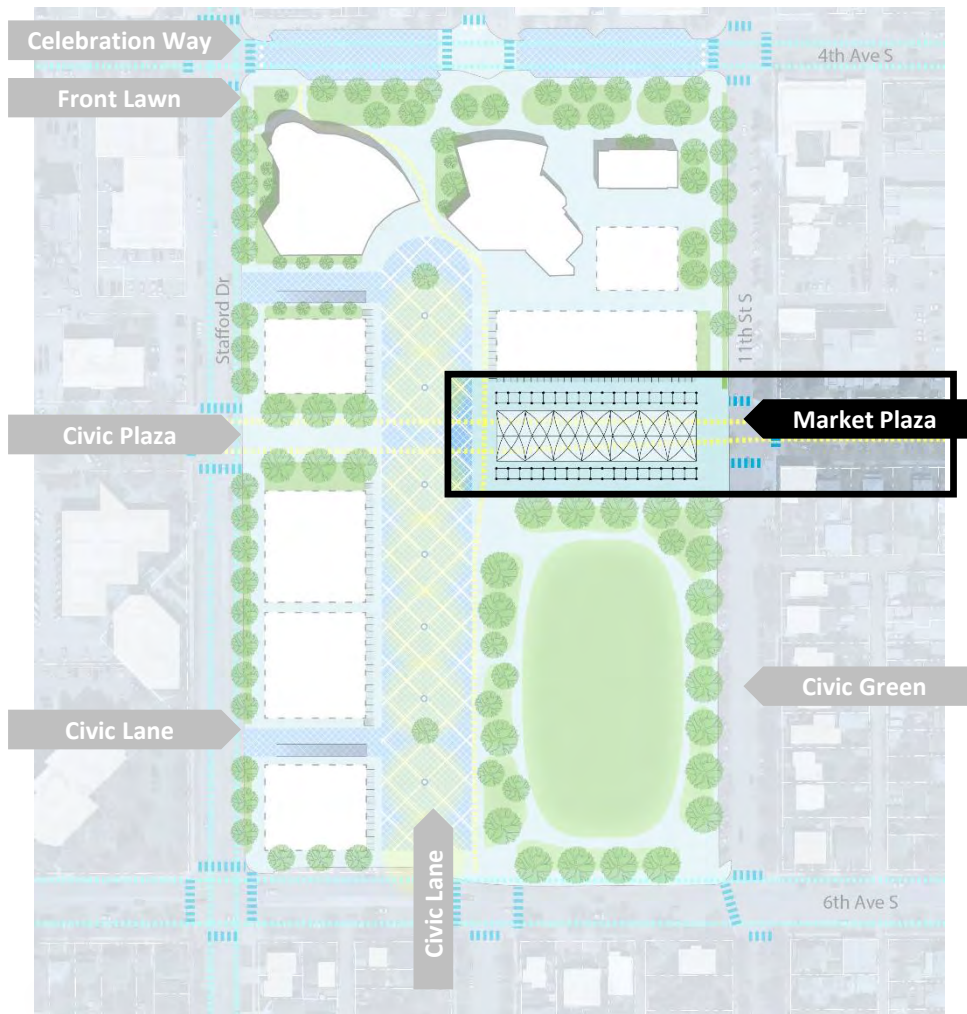

Market Plaza

The **Market Plaza** is designed to support local markets and small events. The supportive event infrastructure provides a plug and play environment within the broader Civic Common landscape. An open framework provides some shade and sets up a geometry for market stalls and events such as Word on the Street. The new Market Plaza creates a pedestrian and cycling connection along 5th Avenue South. The market plaza provides a threshold between the residential neighbourhood to the east and the vibrant Civic Lane to the west.



CITY OF
Lethbridge

Civic Common Phasing Overview

Phasing is flexible and based on listening to the community and taking advantage of opportunities as they arise.

Activation

Civic Lane + Civic Green

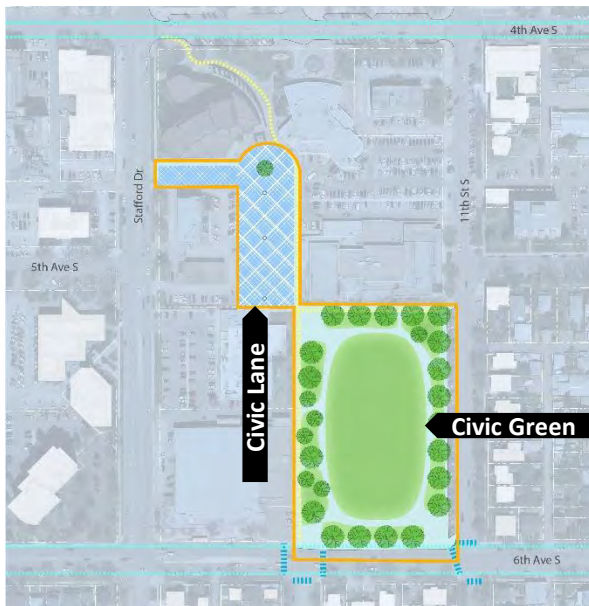

Integration

Front Lawn + Civic Green

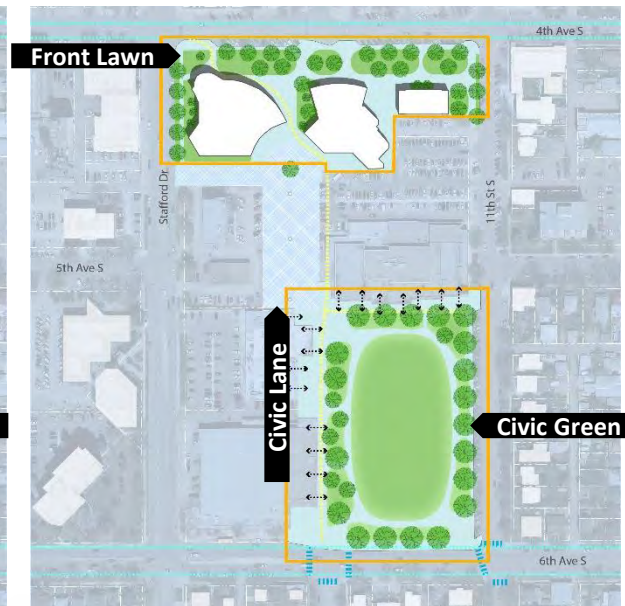

Design + Development

Civic Lane + Civic Plaza + Market Plaza

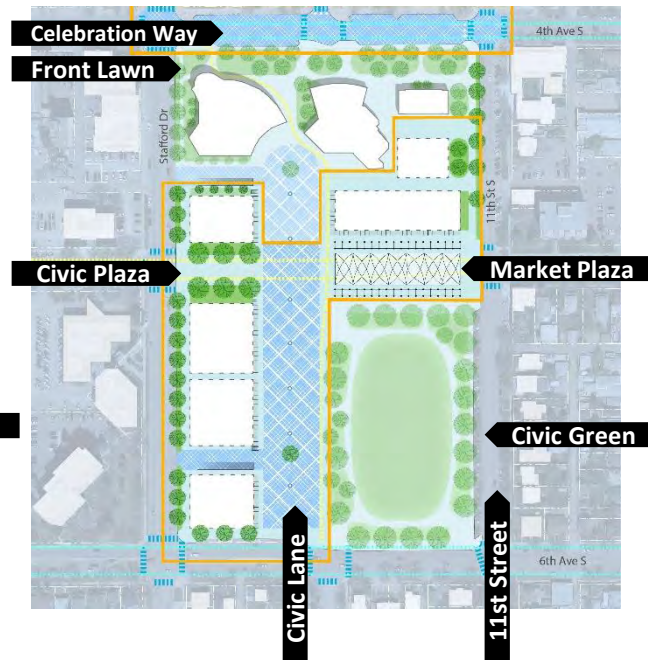

- | | | | |
|--|-----------------------------|--|-------------------------|
| | Multi-Use Hard Surface | | Canopy Structure |
| | Pedestrian Hard Surface | | Event Support Structure |
| | Landscaping | | Active Frontage/Canopy |
| | Multi-Use Path and Lighting | | Civic Building Site |
| | Proposed Bicycle Route | | |



CITY OF
Lethbridge

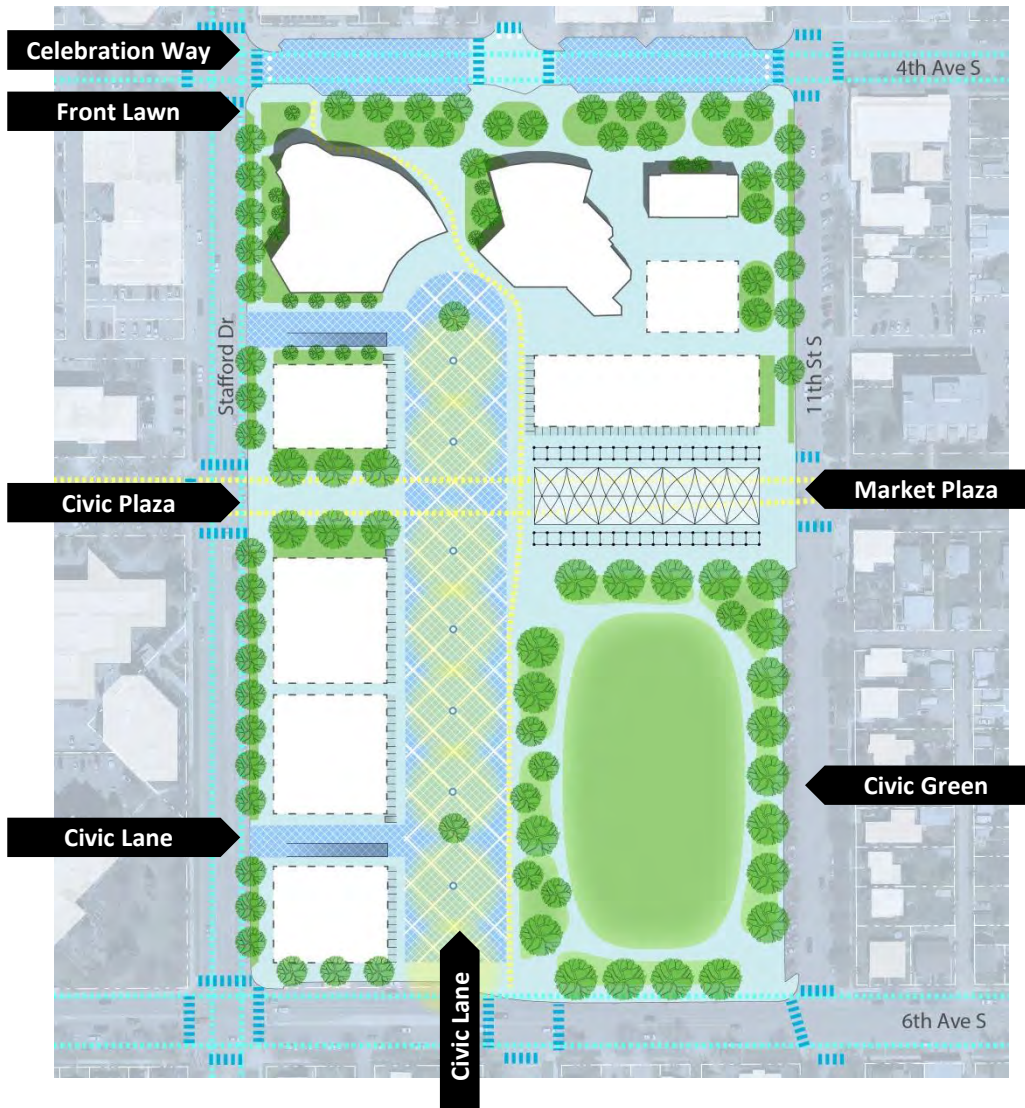

A Common Understanding

- Reanimate the Civic Green
- Prepare the following reports: Public Art Strategy, Parking Study, Traffic Study.
- Audit the City Hall and the Old Courthouse space plan.



	Multi-Use Hard Surface		Canopy Structure
	Pedestrian Hard Surface		Event Support Structure
	Landscaping		Active Frontage/Canopy
	Multi-Use Path and Lighting		Civic Building Site
	Proposed Bicycle Route		



CITY OF
Lethbridge

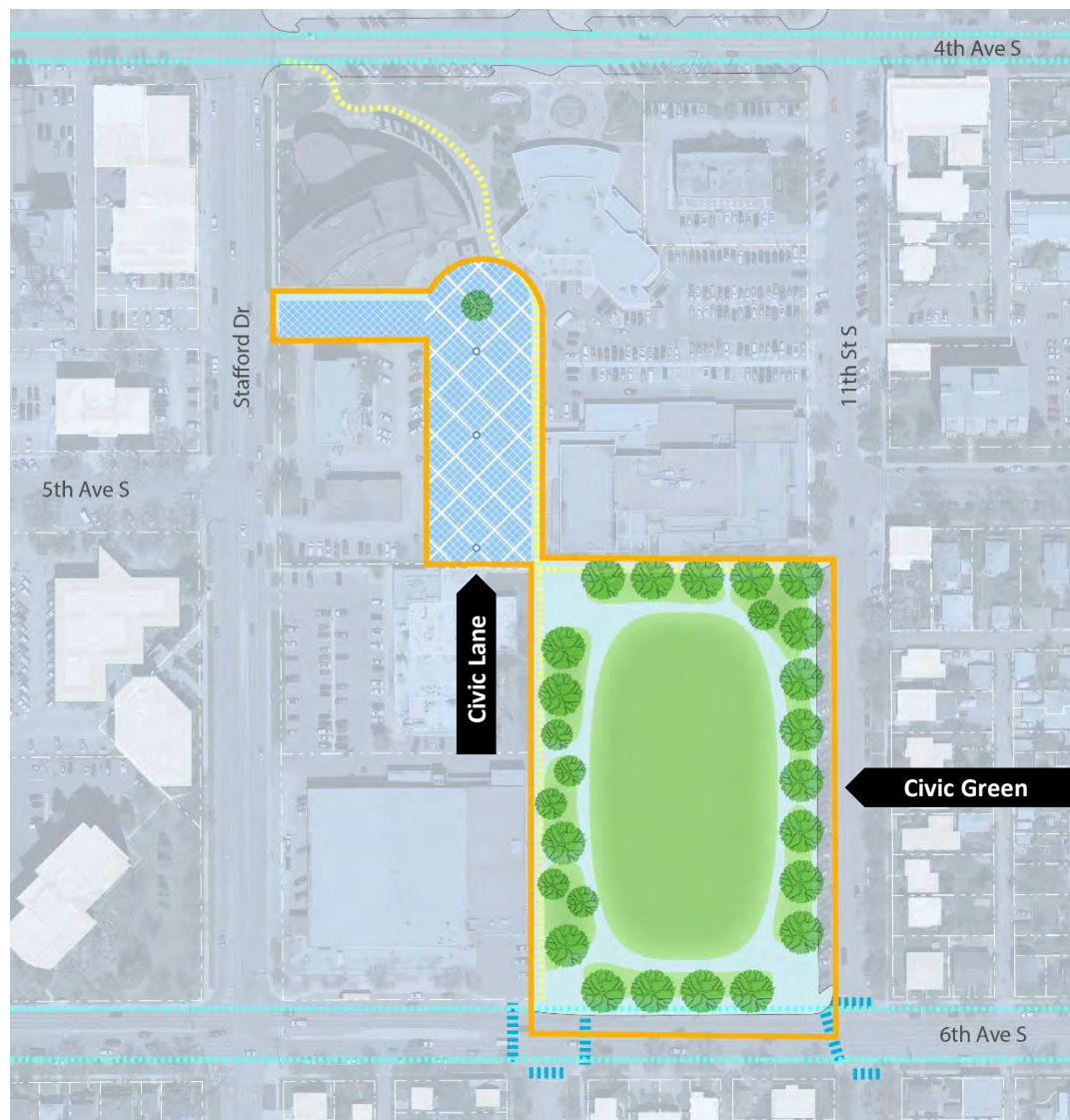

Activation

- Coordinate and increase programming in both the Civic Lane and Civic Green
- Revitalize the Civic Green



	Multi-Use Hard Surface		Canopy Structure
	Pedestrian Hard Surface		Event Support Structure
	Landscaping		Active Frontage/Canopy
	Multi-Use Path and Lighting		Civic Building Site
	Proposed Bicycle Route		



CITY OF
Lethbridge

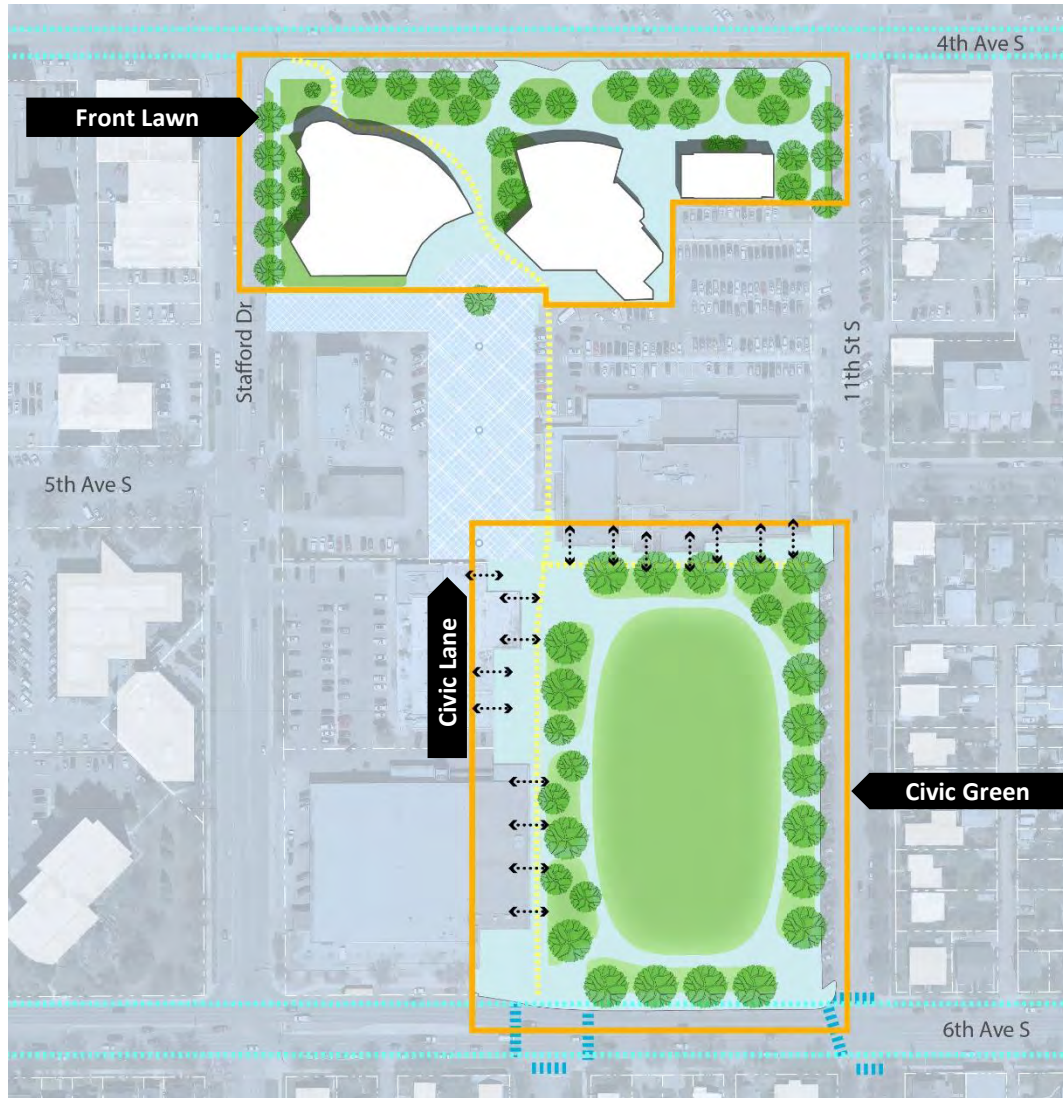

Integration

- Connect and integrate existing and new buildings with public spaces for both the Front Lawn and the Civic Green



	Multi-Use Hard Surface		Canopy Structure
	Pedestrian Hard Surface		Event Support Structure
	Landscaping		Active Frontage/Canopy
	Multi-Use Path and Lighting		Civic Building Site
	Proposed Bicycle Route		



CITY OF
Lethbridge

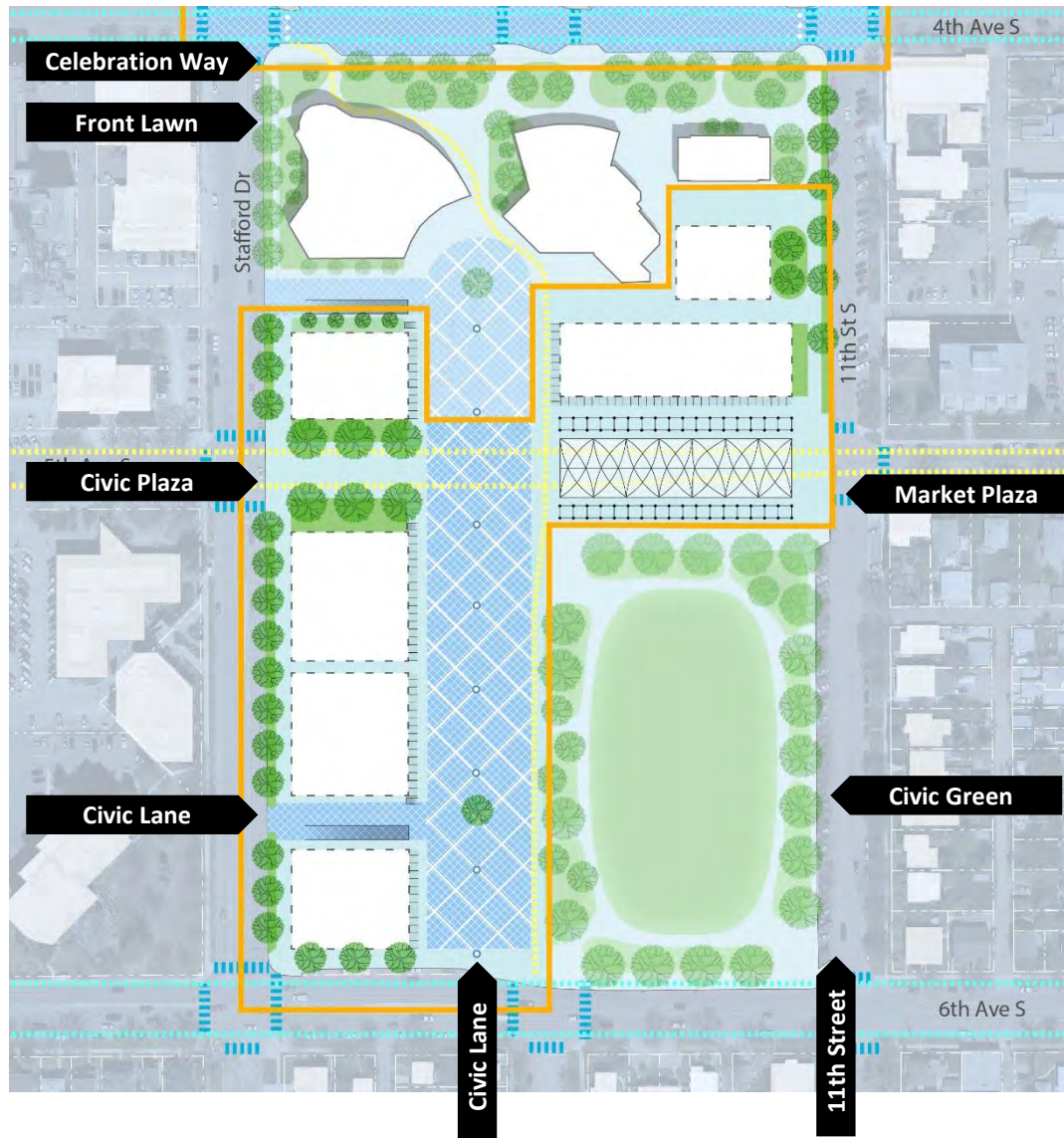

Design + Development

- Complete public realm improvements including the Civic Plaza, Market Plaza and Civic Lane
- Design and develop new civic and community buildings

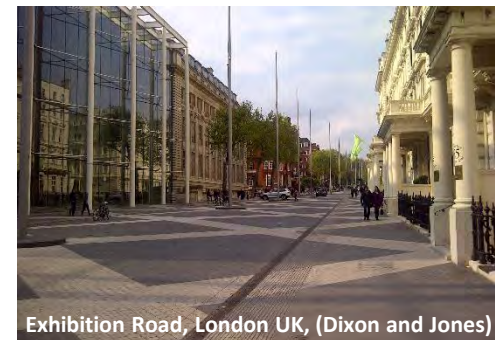

	Multi-Use Hard Surface		Canopy Structure
	Pedestrian Hard Surface		Event Support Structure
	Landscaping		Active Frontage/Canopy
	Multi-Use Path and Lighting		Civic Building Site
	Proposed Bicycle Route		



CITY OF
Lethbridge

Thank you for your participation in
the planning process for the
Civic Common Master Plan.







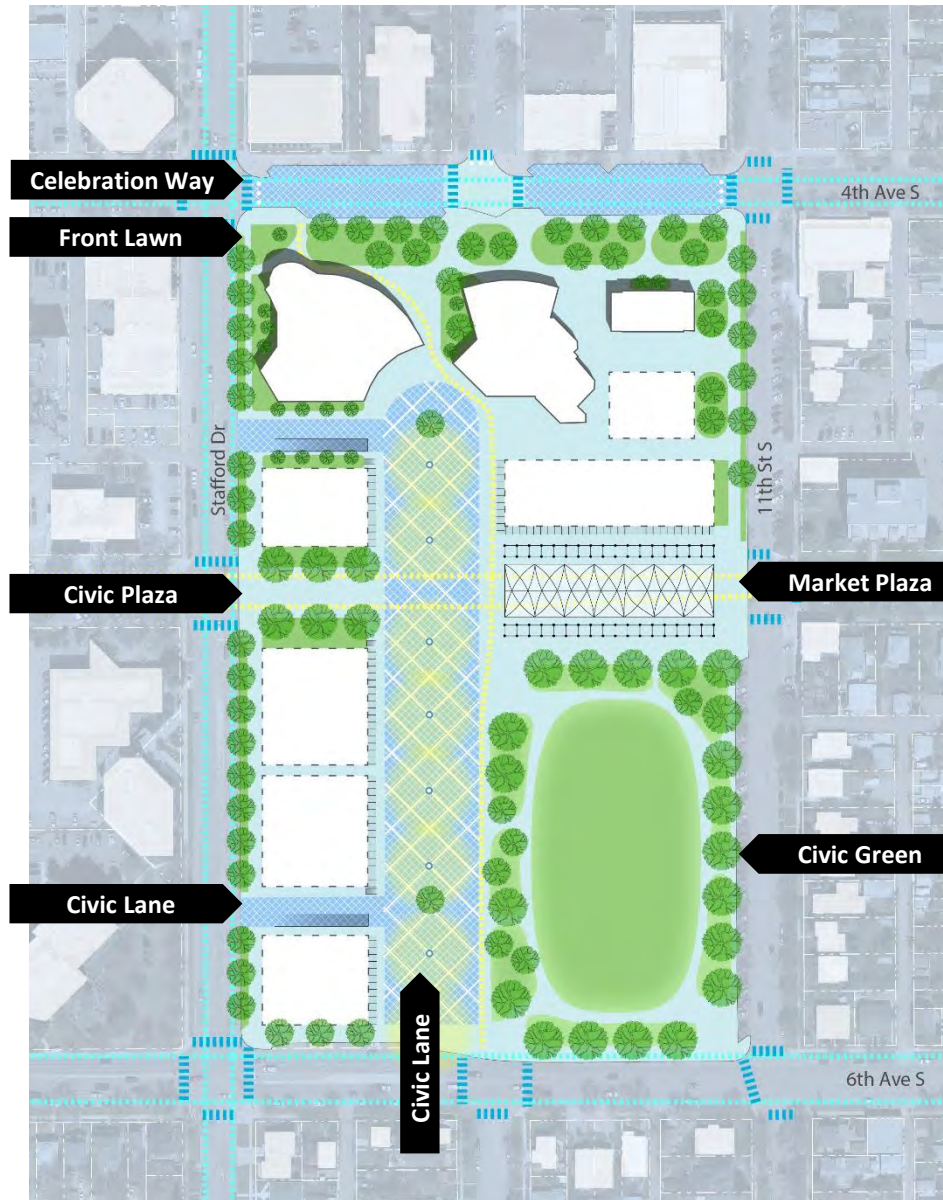

The proposed plan will be
presented to City Council
tentatively at the October 15th
Council Meeting.



CITY OF
Lethbridge

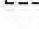

Civic Common Master Plan

-  Multi-Use Hard Surface
-  Pedestrian Hard Surface
-  Landscaping
-  Multi-Use Path and Lighting
-  Proposed Bicycle Route
-  Canopy Structure
-  Event Support Structure
-  Active Frontage/Canopy
-  Civic Building Site



CITY OF
Lethbridge